

HMX EXTERNAL BLINDS

INSTALLATION GUIDE

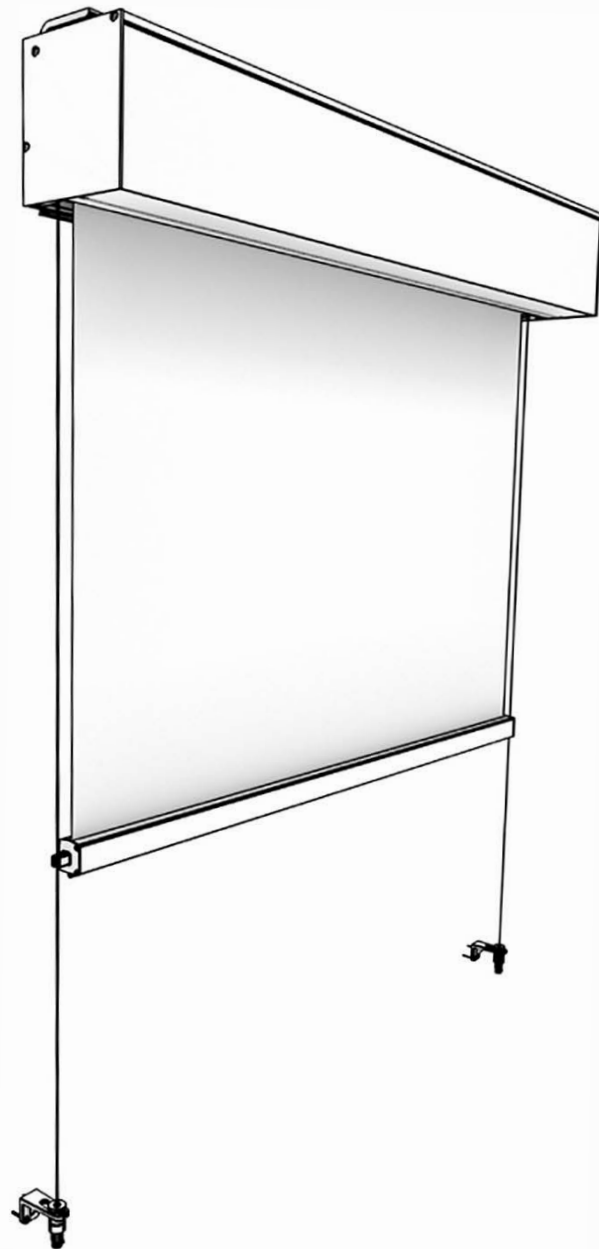

1. SAFETY NOTES, WARNINGS AND MOUNTING INFORMATION

1.1 EXPLANATION OF THE SAFETY NOTES

SAFETY NOTES AND IMPORTANT INFORMATION ARE INTEGRATED IN THE TEXT AS APPROPRIATE. THE FOLLOWING SYMBOLS ARE USED TO ALERT THE READER/USER OF THE INSTRUCTIONS.



This symbol means that the relevant note is important for the safety of persons or for the function of the awning.



This symbol highlights important product information for the installation engineer or user.

1.2 GENERAL SAFETY INFORMATION



These Helioscreen systems have been designed and manufactured in conformity with DIN EN 13561. However, when the awning is mounted or operated, the persons involved in the respective activity may be put at risk if the relevant instructions are not observed.



Only qualified and duly specialised companies or trained specialist personnel may be permitted to mount the awning.



Always observe the information and notes in the Mounting and Operation Instructions. A failure to observe the relevant information will render the manufacturer's liability null and void.



Electrical installation work and connections to the mains must be carried out exclusively by a licensed electrical company.



If significant differences make the safe installation of the awning seem doubtful, please consult the manufacturer of the system and a mounting/installation specialist.

The safety-at-work and accident prevention regulations specific to each country must be complied with. In particular, a person performing special work at height must be suitably secured.

The notes on the product and its packaging must be observed.

1.3 INSTALLATION PREPARATION



Transport the awning to the place of installation in the correct position. The drive side is indicated on the packaging.



Secure the installation area; at least the area equivalent to the extended awning.

When pulling up the awning into higher installation positions by means of ropes the awning is to be removed from the packaging. The pull ropes are to be attached so that the awning is securely fastened, but is not damaged. The awning may only be raised in the horizontal position and uniformly.

Before starting the installation, check whether the type and number of brackets match the order and whether the installation surface (substrate) matches the surface given in the order. In the event of significant differences, which make safe and secure fixing of the awning questionable, consult the system manufacturer and a fixing technology specialist.



Failure to comply can result in the awning falling off and therefore can cause injuries!

2. INSTALLATION

2.1 TOOLS AND MATERIALS



SW 17
SW 19

SW 5

2.2 INSTALLATION DIMENSIONS

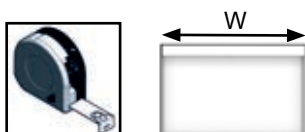

Side guide rail

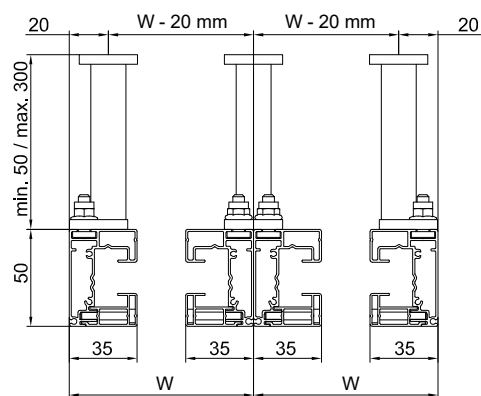
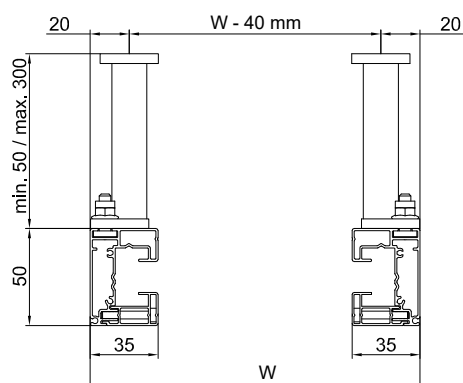
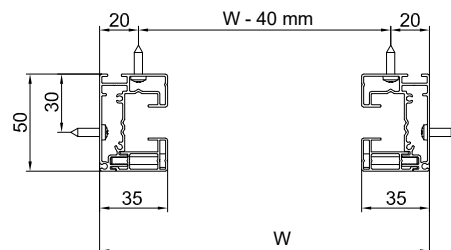
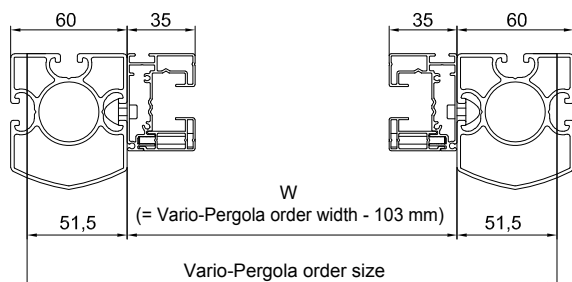

2.2 INSTALLATION DIMENSIONS

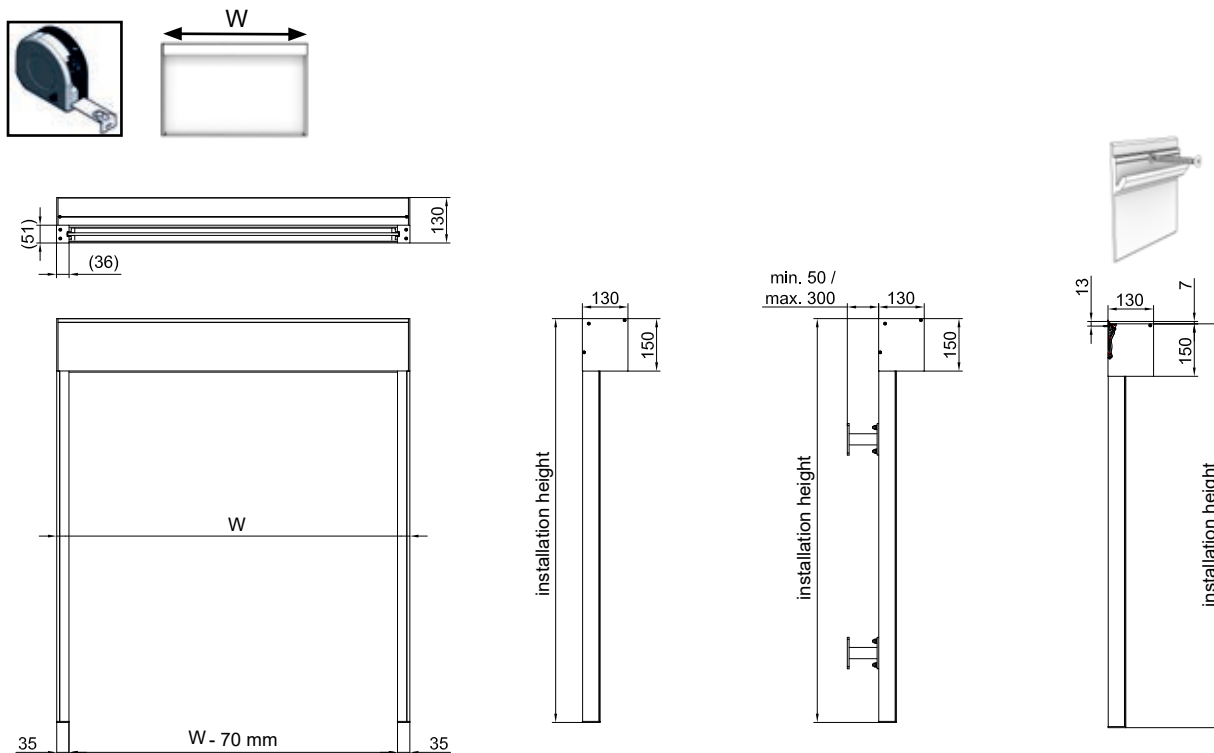

2.3 STAINLESS STEEL GUIDE CABLE BOTTOM TERMINAL OPTIONSSTAINLESS STEEL GUIDE CABLE BOTTOM TERMINAL OPTIONS

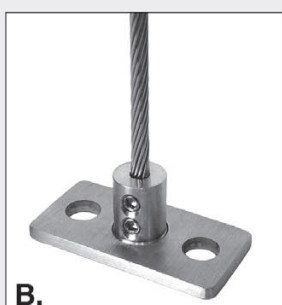

Side Guide Fittings Dimensions (mm)

- A. Bracket size – (h)80, (w)25, (p)40
(size of bush 18 x 20, plus thread 20)
- B. Overall size – (h)15, (w)40, (d)20
- C. Bracket size – (h)30, (w)40, (d)40
(size of bush 18 x 20, plus thread 20)
- D. Deck screw size – (w)19.5, (h)38
- E. Overall height to baserail – 110

SIDE GUIDES

SERIES 1

- A. S/Steel Bush
S/Steel Wall Bracket
- B. S/Steel Bush
S/Steel Bottom Fix Plate
- C. S/Steel Bush
S/Steel Universal Bracket
- D. S/Steel Timber Deck Mount
- E. Swivel Snap Hook, with Saddle

SERIES 1

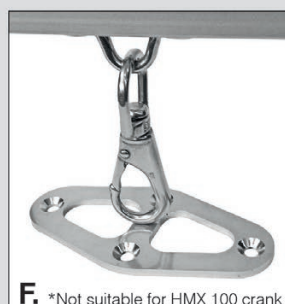

Side Guide Fittings Dimensions (mm)

- F. Overall size – 125 x 60 x 4, (h)90
(floor to bottom of baserail)
- G. Bracket size – (h)80, (w)25, (p)105

SERIES 2

- F. Swivel Snap Hook, with Floor Plate
(needs recess underneath)
- G. Reverse Roll Stand-out Brackets

SERIES 2

2.4 INSTALLATION WITH STAINLESS STEEL GUIDE WIRES

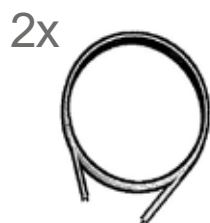

Stainless steel guide wires



Cable bottom fixings

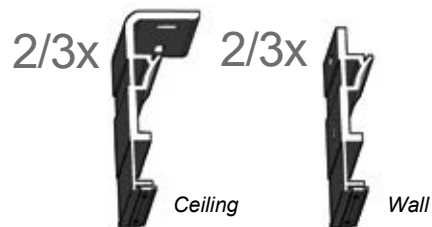

Optional wall / top fix brackets

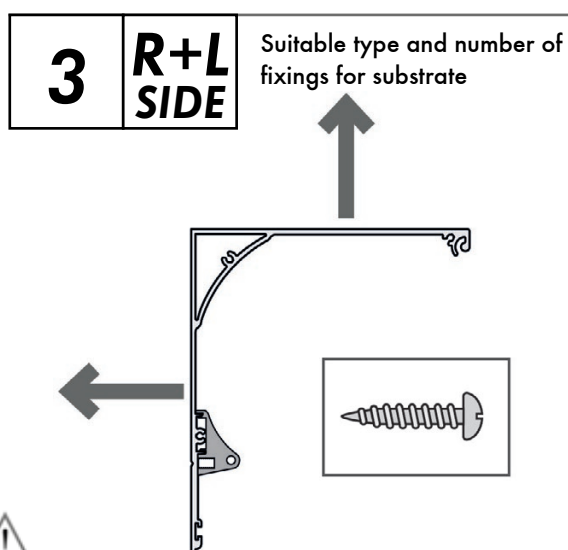
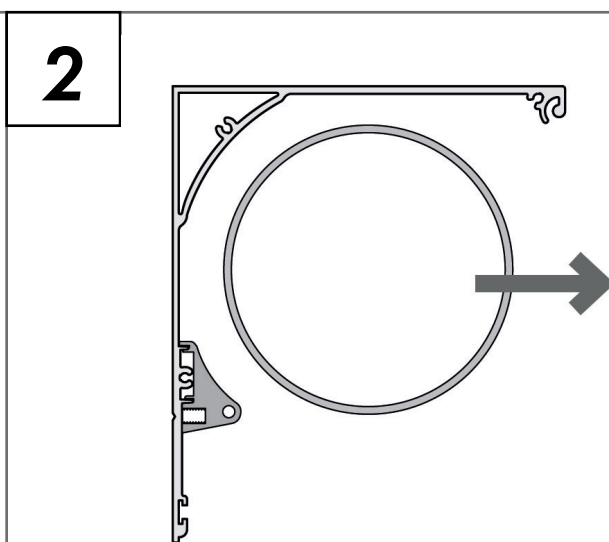
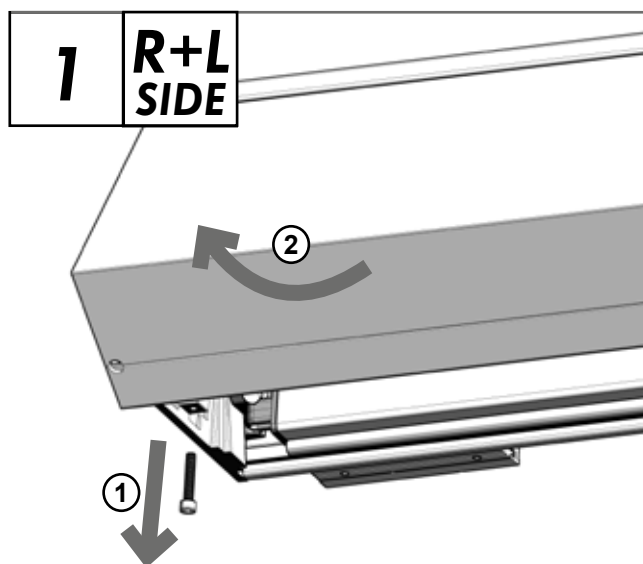

Caution! Take care to position fixings where they will not make contact with the fabric and cause damage!

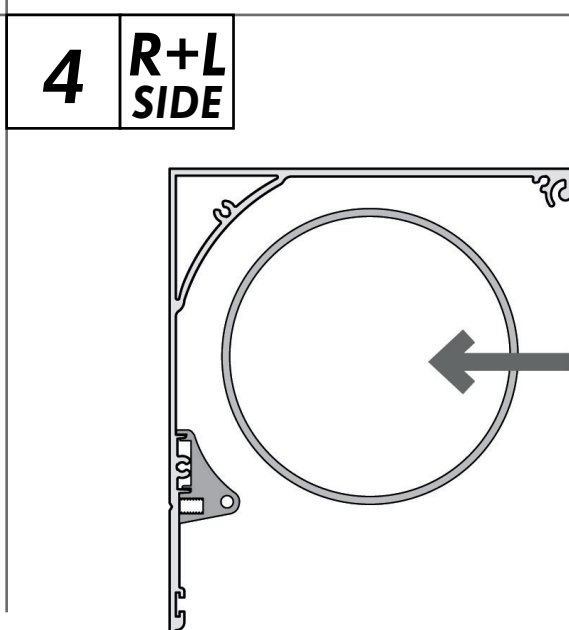

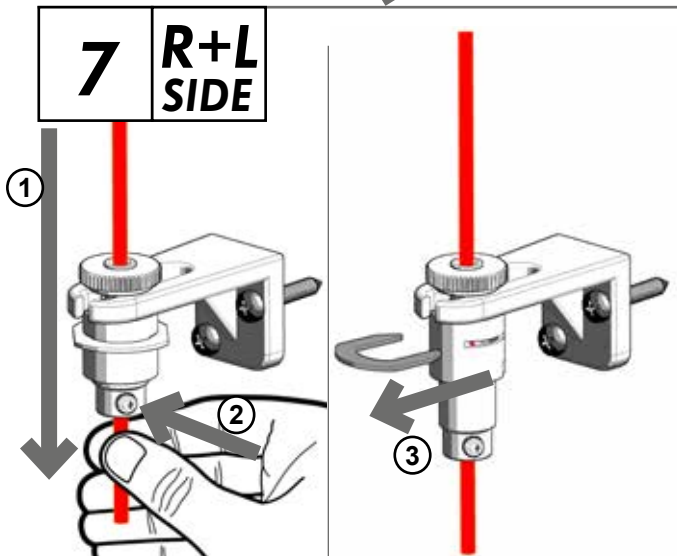
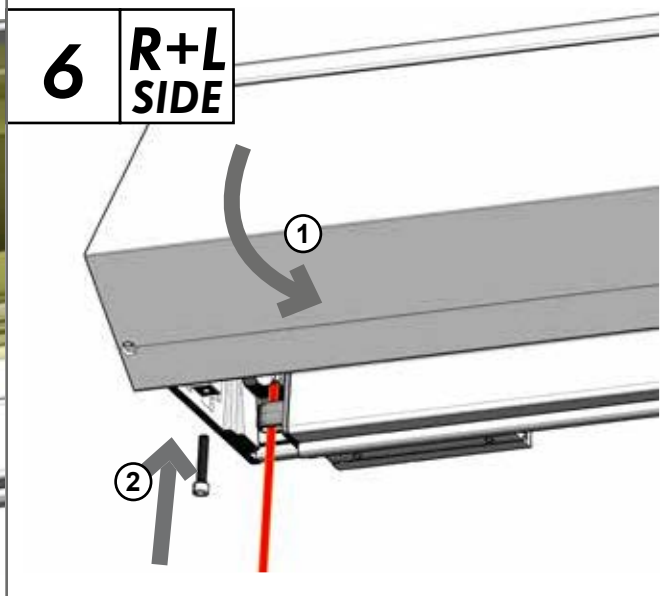
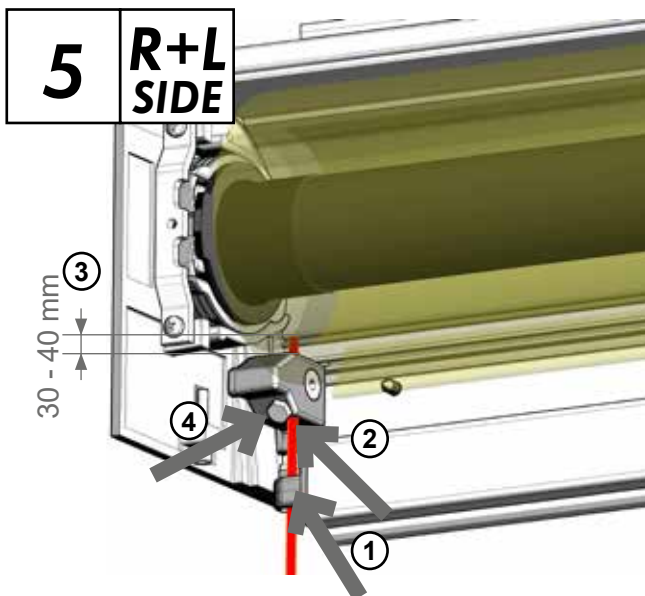

Cable termination may vary depending on site

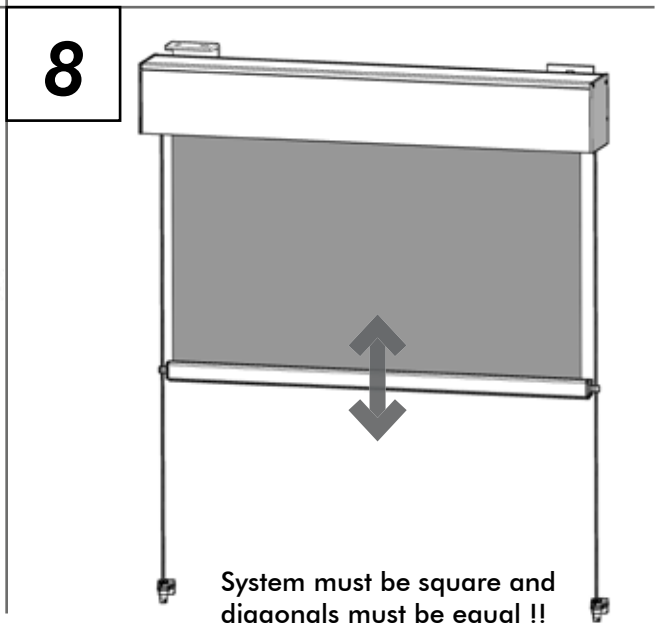

2.5 OPTIONAL WALL / TOP FIX HEADBOX BRACKETS - CABLE GUIDE ONLY

1

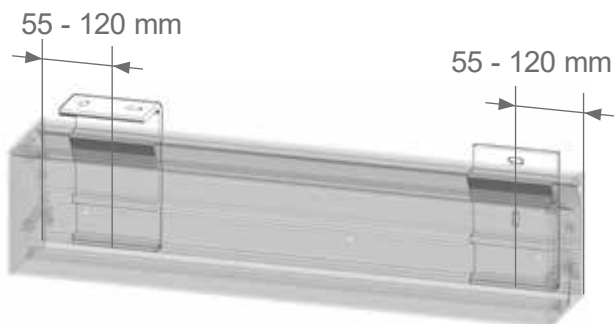

2

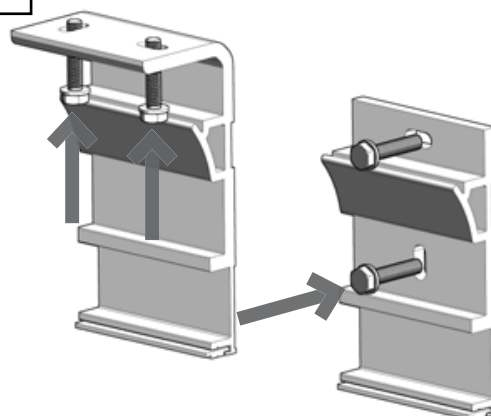

3

**R+L
SIDE**

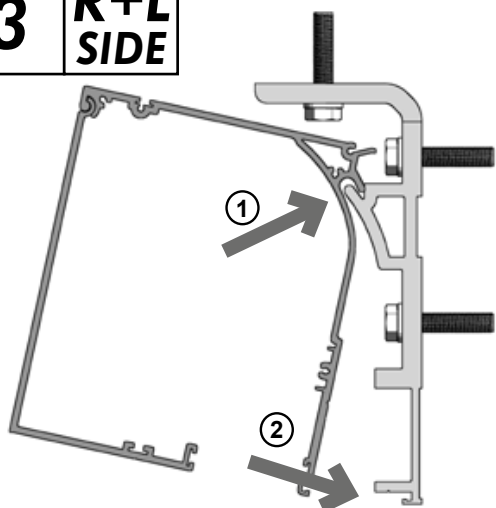

4

**R+L
SIDE**

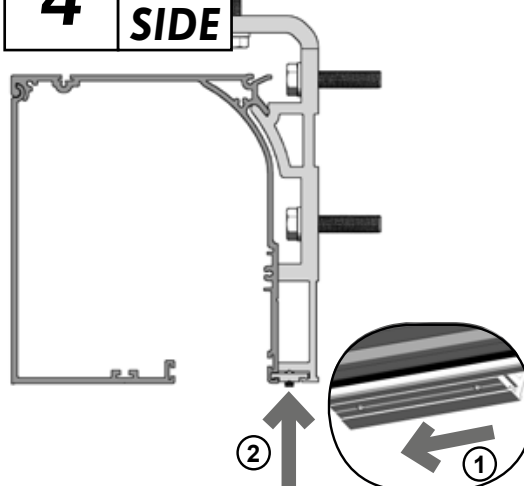

For widths up to 5m, minimum 2 brackets must be used. For widths over 5m, minimum 3 brackets must be used. Final number of brackets will vary depending on substrate. Always use extra brackets where required.

2.6 INSTALLATION OF OPTIONAL HEADBOX SUPPORT PLATE (OVER 5M WIDTH) - CHANNEL GUIDE ONLY

1

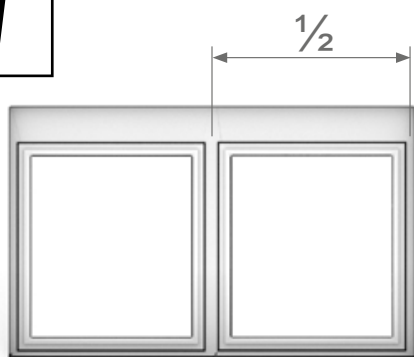

2

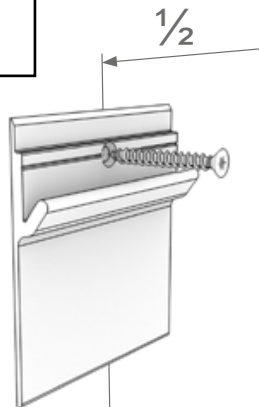

3

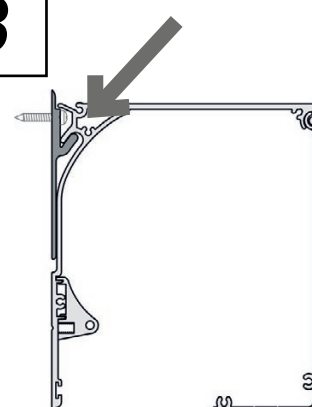

NOTE: If system is over 5m wide and optional headbox support plate is not used, fixings from inside of the headbox can be used to support the headbox. In this case the roller tube and fabric should be removed.



Caution: Take care to position fixings where they will not make contact with the fabric and cause damage!

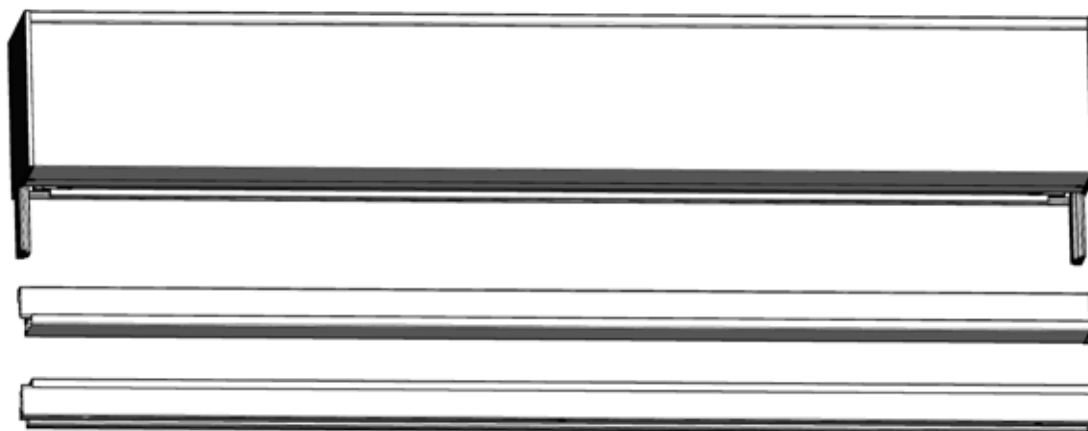

Suitable fixings
by client / installer

1



Work on a soft surface only!

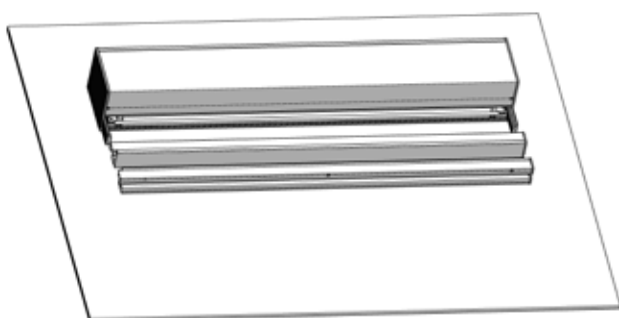

2

**R+L
SIDE**

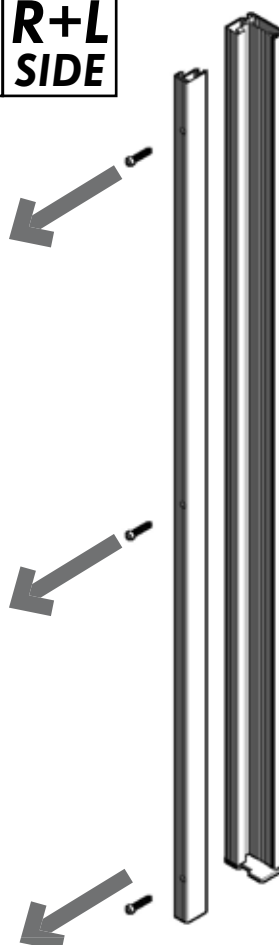

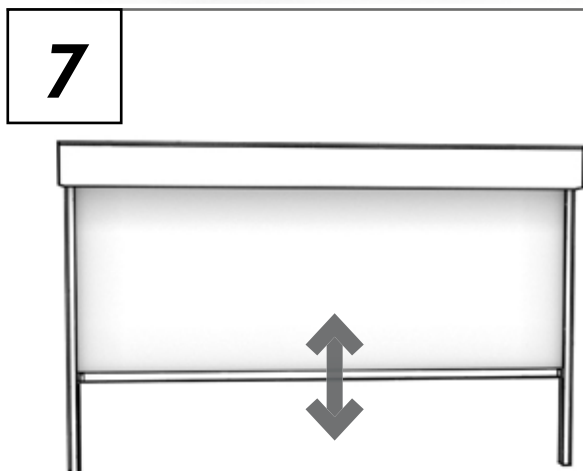
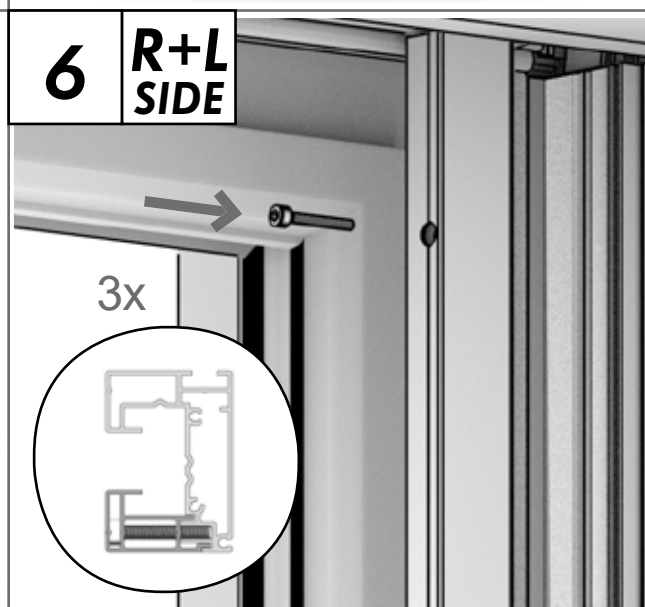
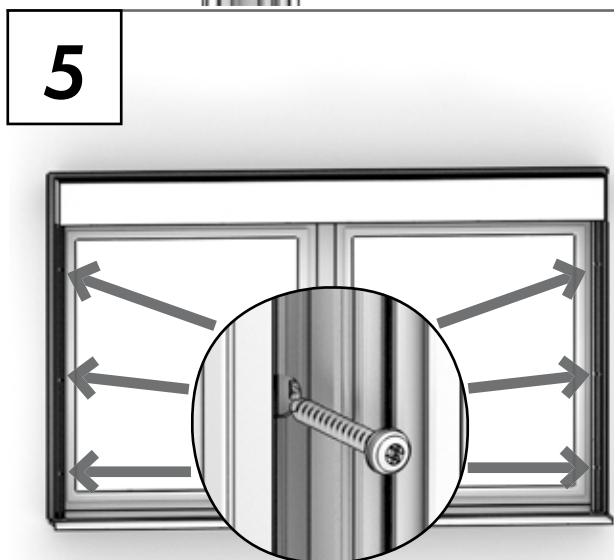
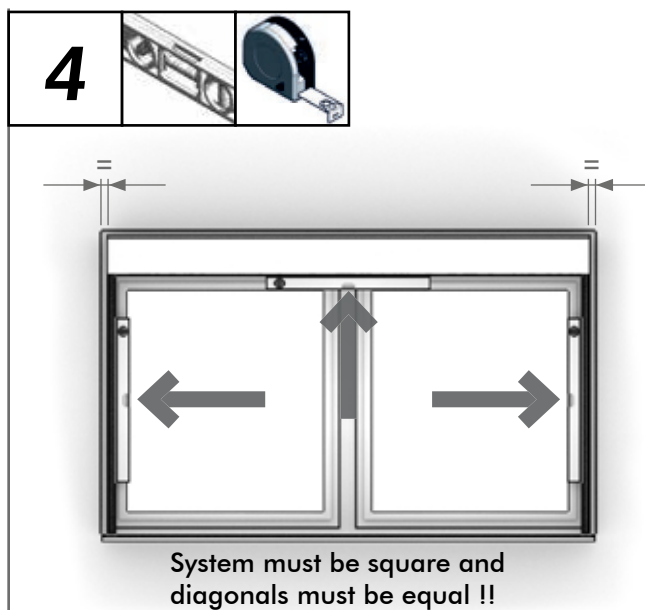
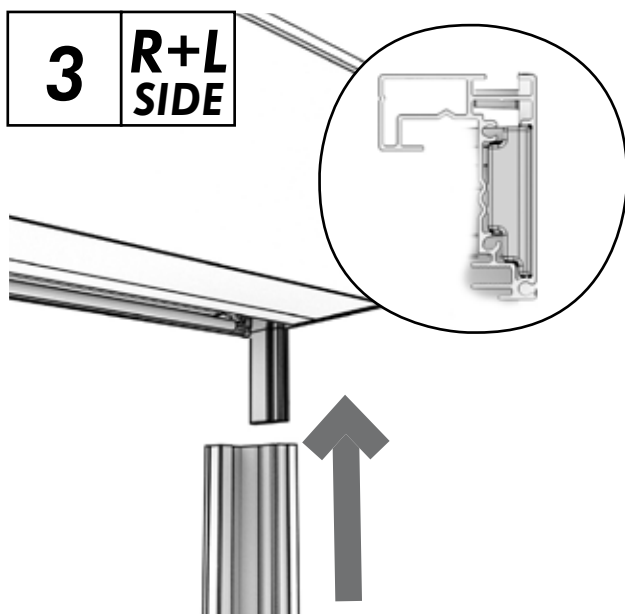

System must be square and diagonals must be equal !!

2.8 INSTALLATION WITH OPTIONAL DISTANCE BRACKETS (SIDE GUIDE CHANNELS)

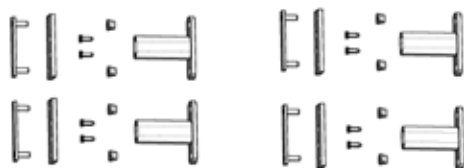
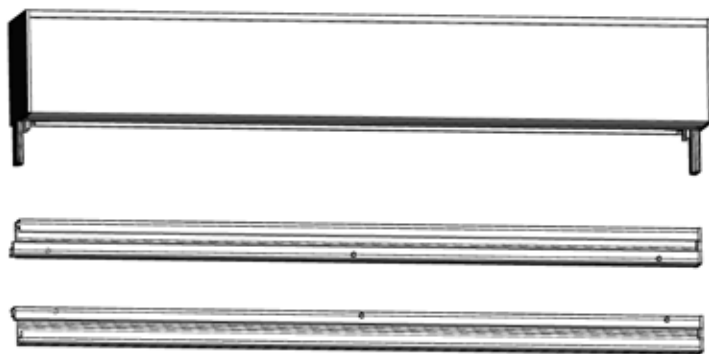

Suitable
fixings by
client /
installer

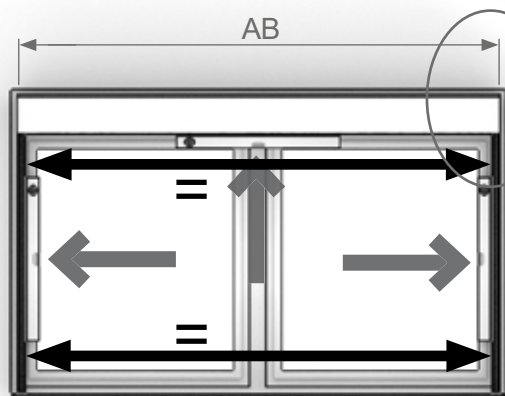

2 **R+L
SIDE**

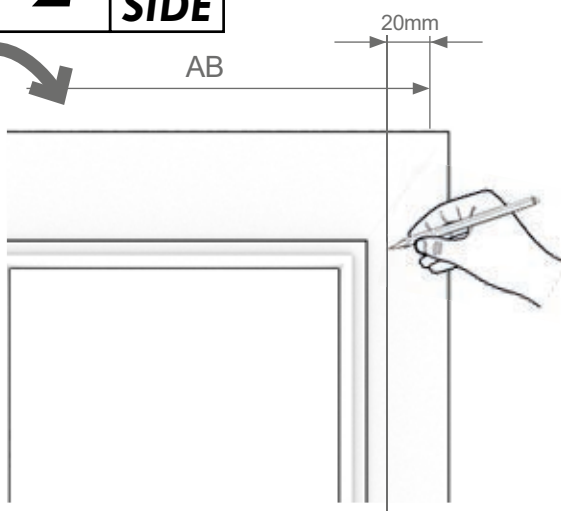

3 **R+L
SIDE**

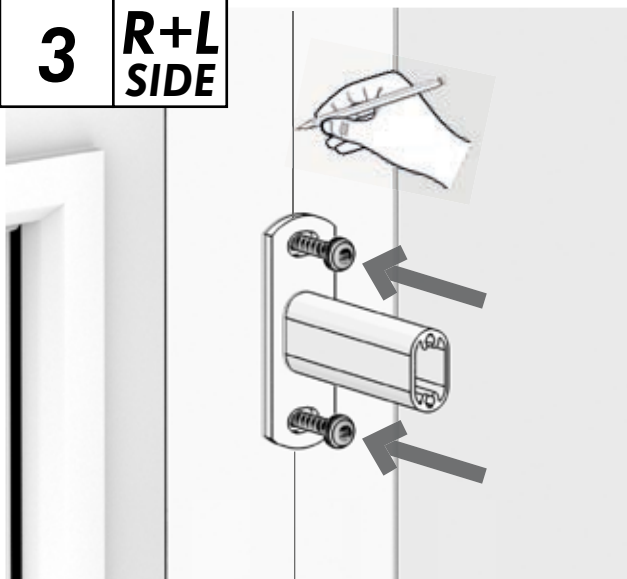

4 **R+L
SIDE**

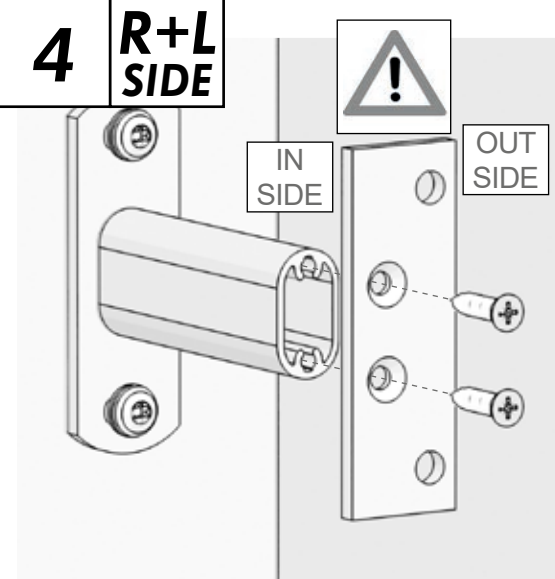

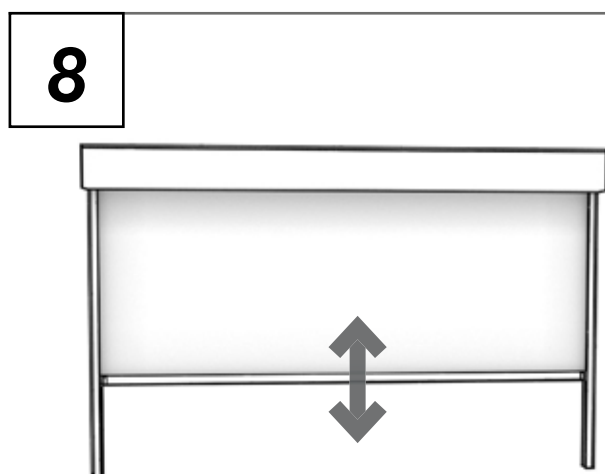
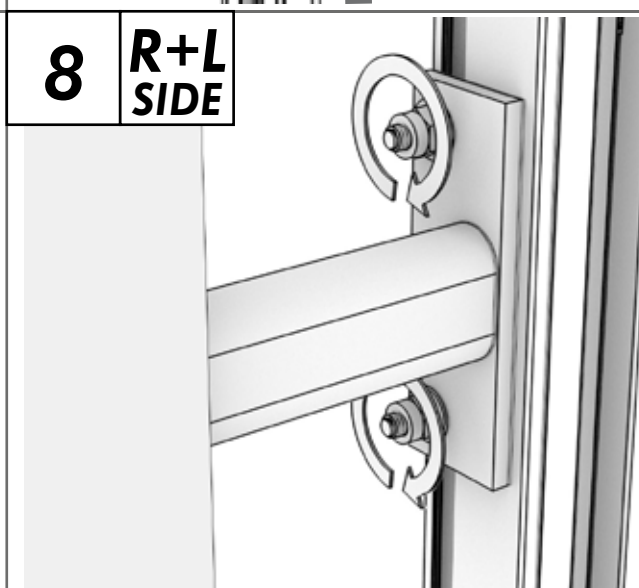
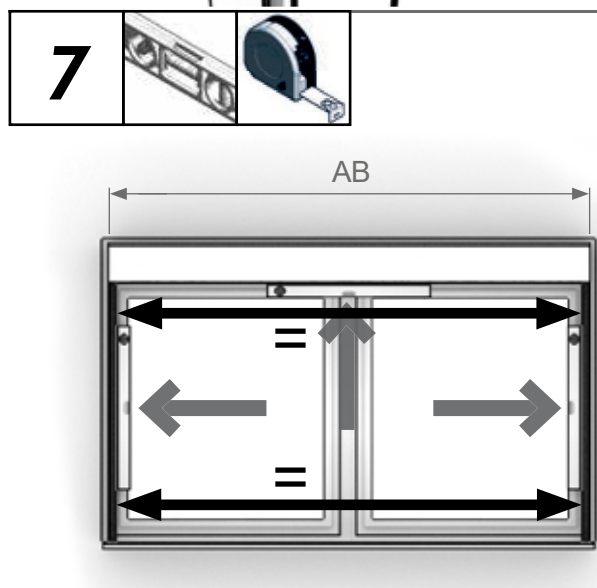
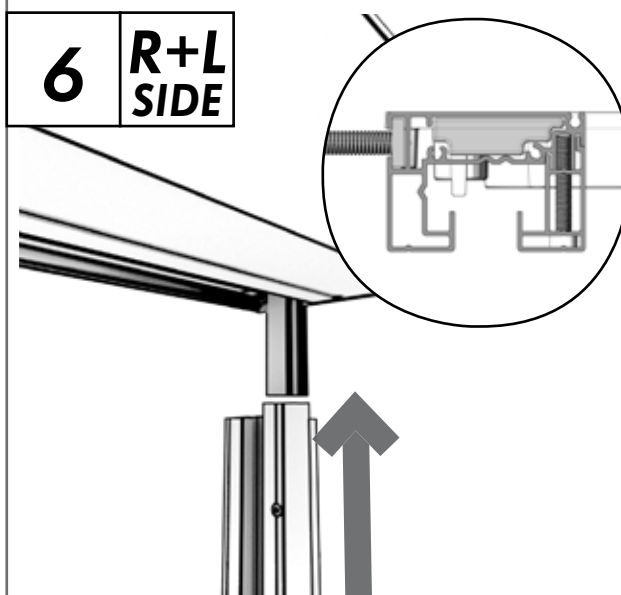
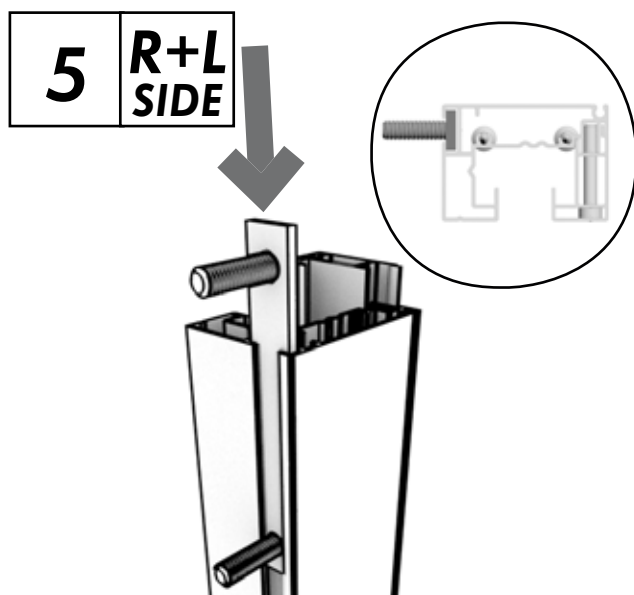

System must be square and
diagonals must be equal !!

3. SETTING MOTOR LIMITS

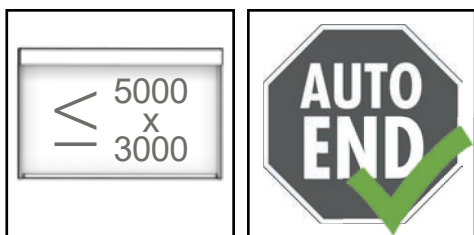

4. OPENING THE INSPECTION COVERS

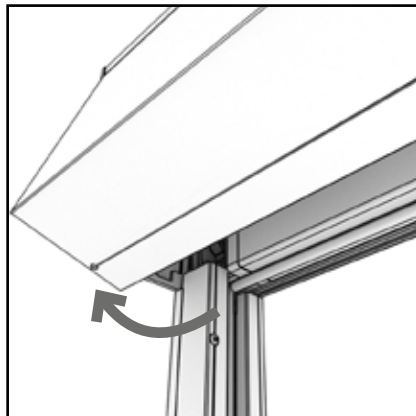
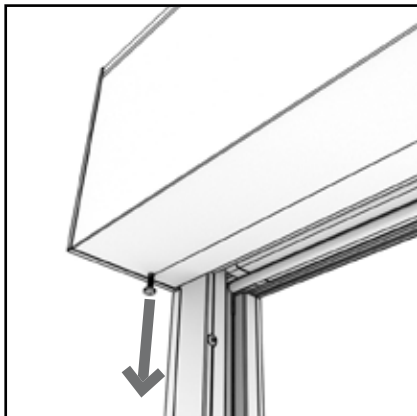

5. INITIAL OPERATION

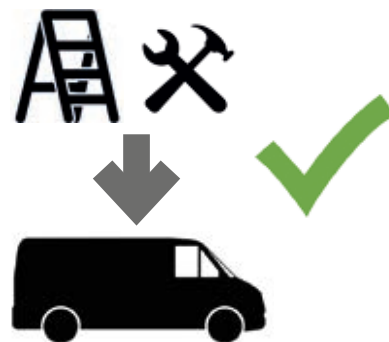
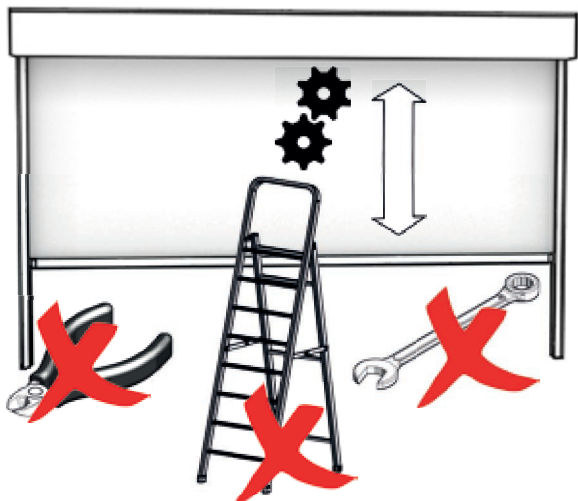
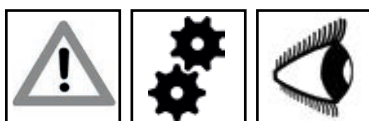

Remove all transport protection materials (card, foam piece between blind and box, styrofoam pieces).

For test runs with motorised systems, always use the control cable. The operator must always have sight of the system during the test run.

- Completely retract and extend the system again and check the end positions.
- The bottom rail must not rest on the window sill when in the end position.
- Adjusting the motor end stop is explained in the motor setting instructions enclosed

6. REMOVAL

1

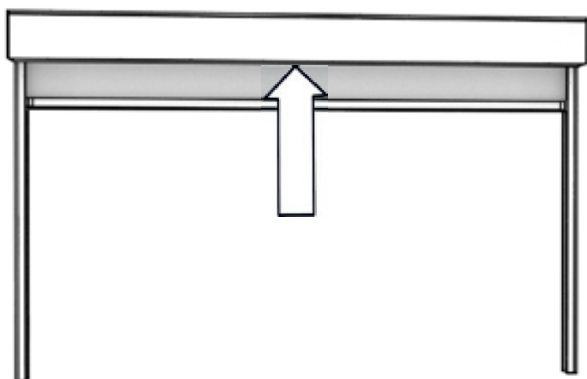

2

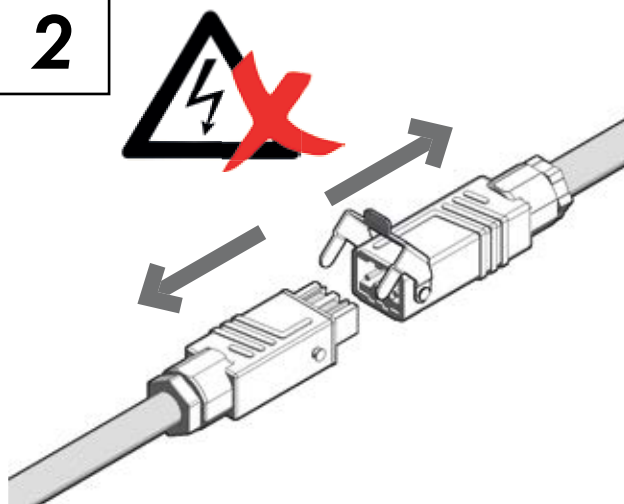

3

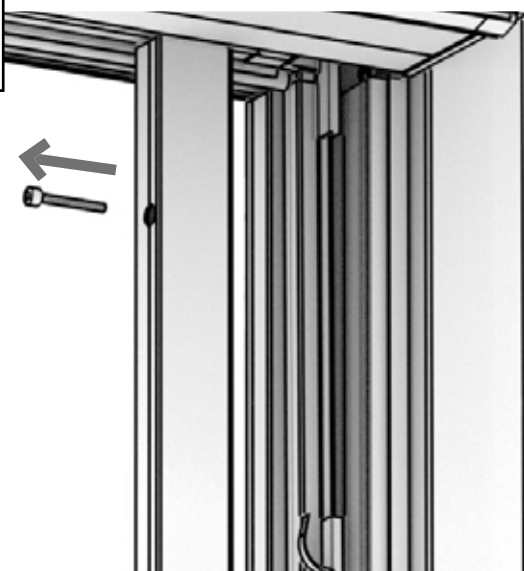

4

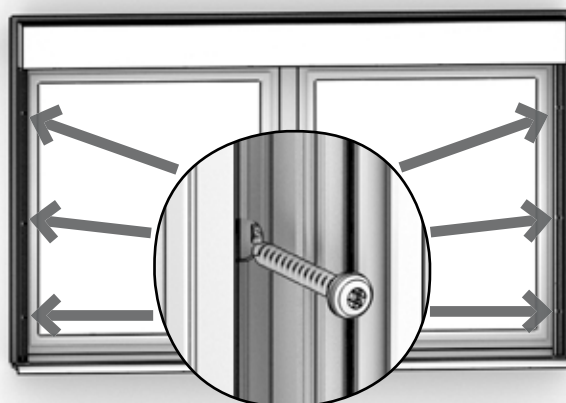

1

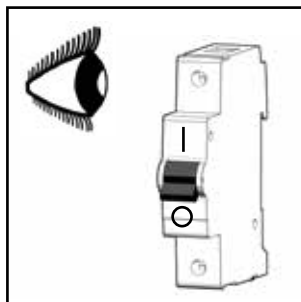
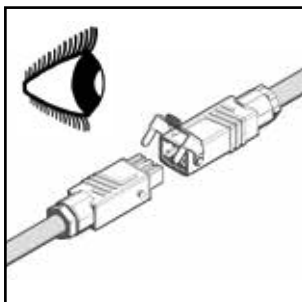

2

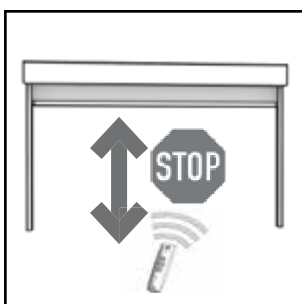
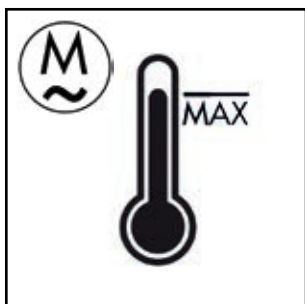

3

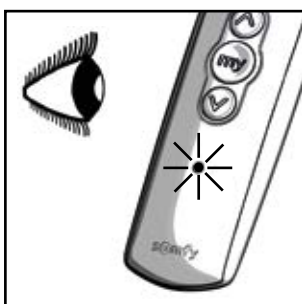
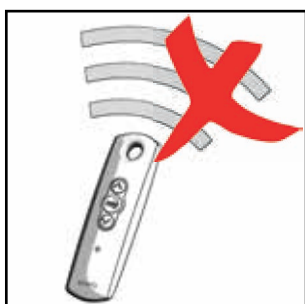

4

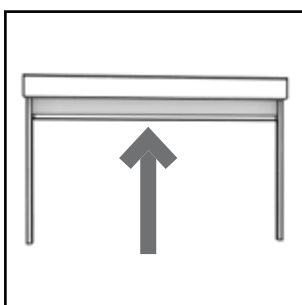
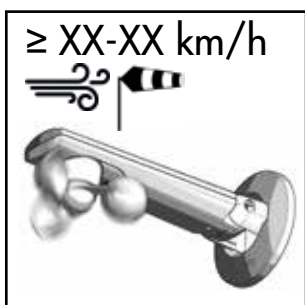

7. TROUBLESHOOTING

System does not extend or retract fully

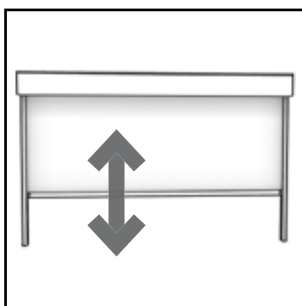
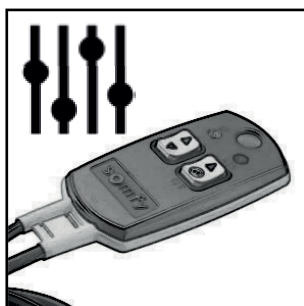
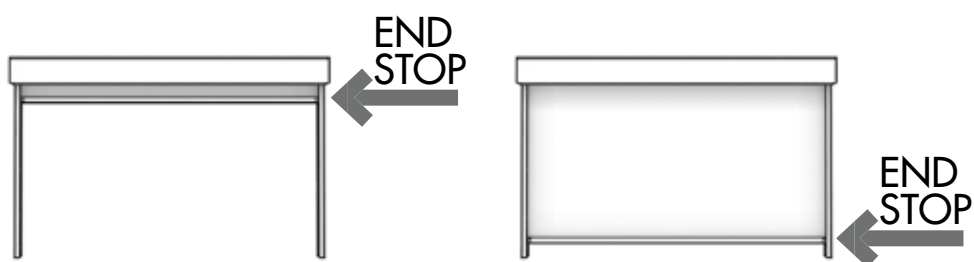

System does not close on one side

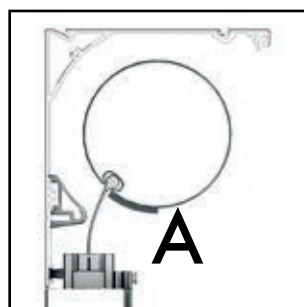
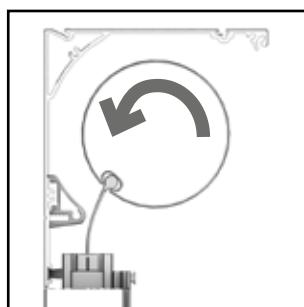
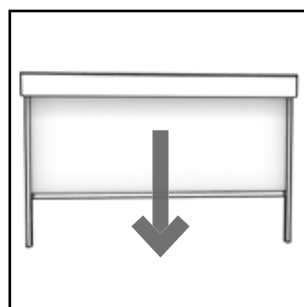
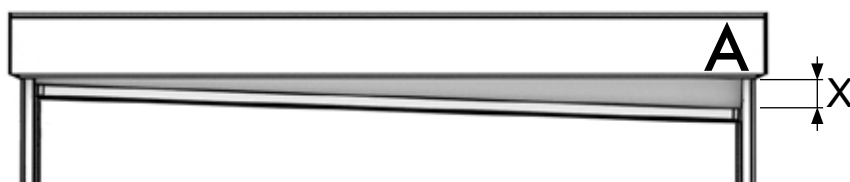

A

Fabric duct tape

Awning fabric sags or makes creases

