

SYSTEM SPECIFICATIONS

System	Vario-pergola self-supporting sunroof
Minimum width	1000mm
Maximum width	6000mm
Maximum projection	6000mm
Maximum size	25sqm
Coupling system	Endless systems can be coupled together side-by-side
Installation angle	0-35°
Standard operation	Remote or switched motors
Fabric colours	Over 150 fabric colours
Standard frame colours	Over 120 Dulux and custom powdercoat colours
Premium frame colours	Over 50 Dulux Duratec and Electro commercial colours

TECHNICAL INFORMATION

Headbox	235 x 154mm 2 piece headbox
Control end	Automated with remote control Connection to Building Management System (optional)
Roller tube	Galvanised steel 85/95mm diameter 2mm wall thickness
Front bar	Single part aluminium profile 91.5 x 44mm, wall thickness 2.5mm
Front posts	60 x 60 x 4mm aluminium square tube. 150 x 150mm floor fixing plates
Mounting	Aluminium wall brackets with adjustable tilting range of 0-35° Top fix mounting brackets available
Fabric support roller	All units come with fabric support roller(s) included
Sun and wind control systems	Optional automation via Soliris sun and wind sensor Automated reaction in high winds Adjustable wind sensitivity levels



Vario-pergola

RETRACTABLE SUNROOF



The **Vario-pergola** self-supporting sunroof adds a new dimension to the Helioscreen outdoor living range.

The **Vario-pergola** is suitable for a wide variety of applications and is more flexible than traditional conservatory or winter garden awning products. It can be installed using wall or ceiling brackets and doesn't require a traditional substructure, as it supports itself on 60x60mm square front posts.

Lightweight but robust, the **Vario-pergola** is based on the popular **Varioscreen®** system and comes with in-built water gutters on the side channels allowing outdoor areas to be utilised in light rain.

The Vario-pergola is an attractive addition to any building and extends outdoor living spaces – all year round.

System layout



Single system – One motor



Side track

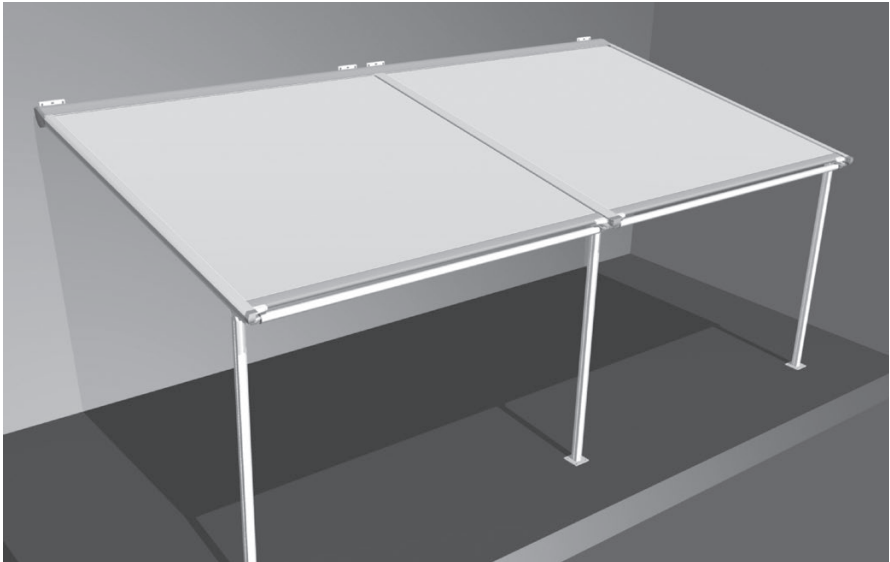

Coupled system – Two motors

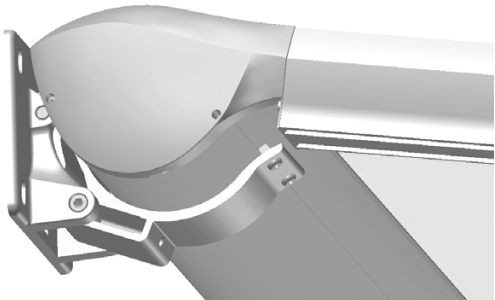

Wall bracket detail

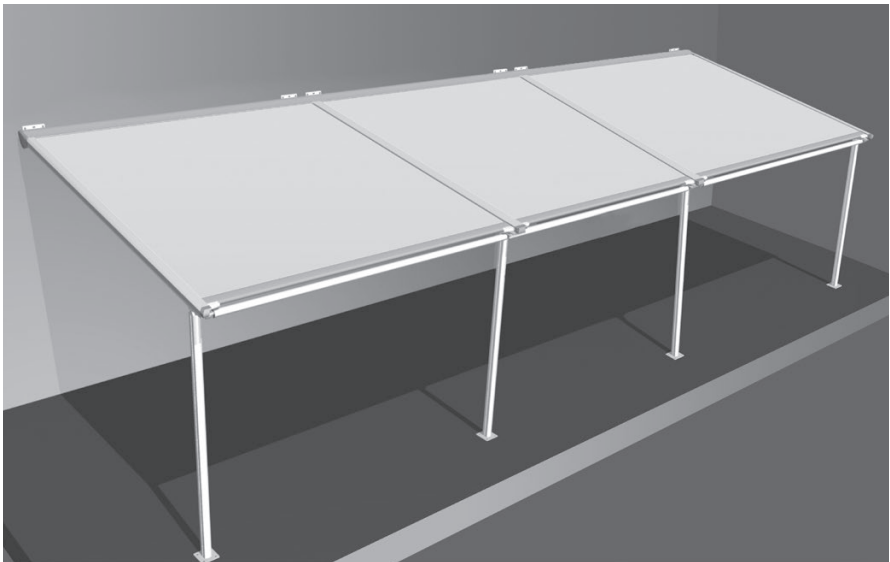

Triple system – Three motors



Front post

Mounting situations

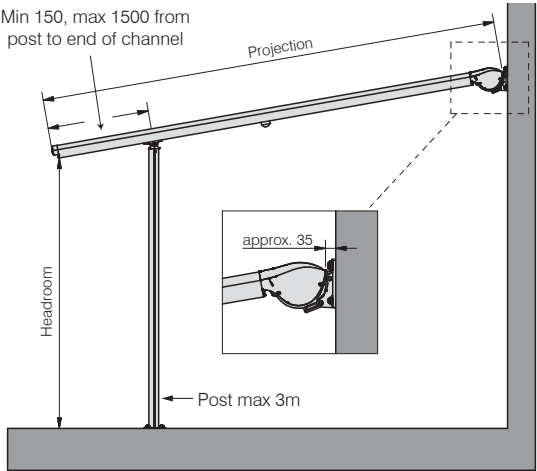

Wall mount

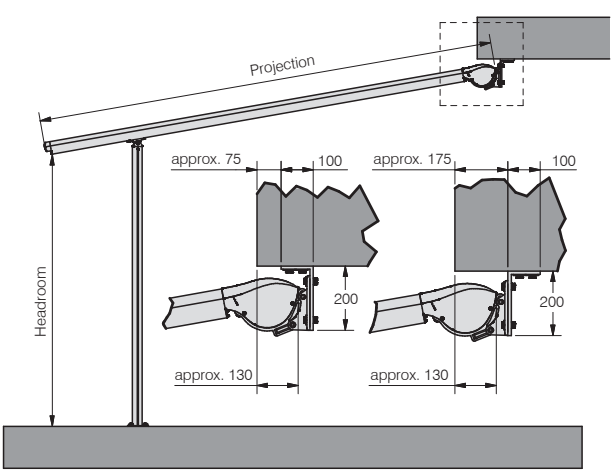

Top mount

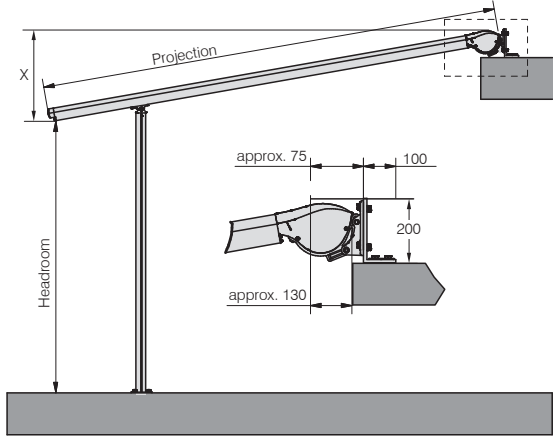

Down fix

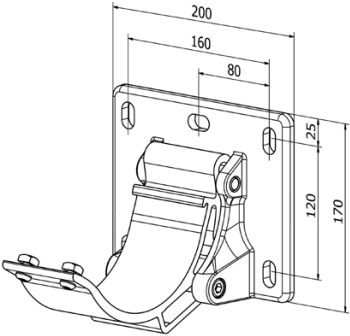

Wall mount bracket
5 Holes: 14 x 24mm
Tilting range 0-35°

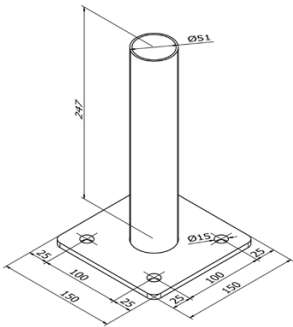

Fixing plate for post

VARIO-PERGOLA: Fall chart

Projection (m)	At 15 degrees "X" is equal to: (mm)
1.00	358
1.50	487
2.00	617
2.50	746
3.00	876
3.50	1005
4.00	1134
4.50	1264
5.00	1393
5.50	1523
6.00	1652

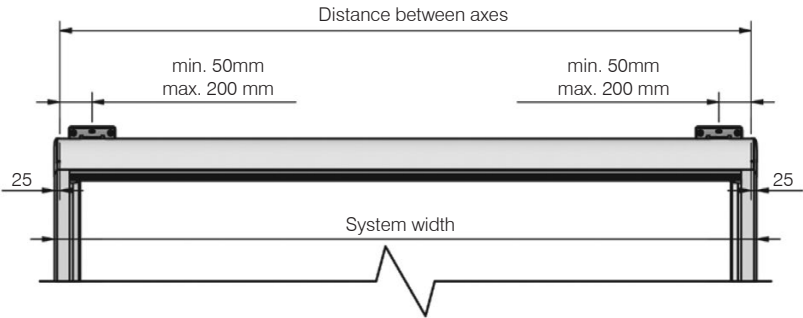

Bracket positions

System layout

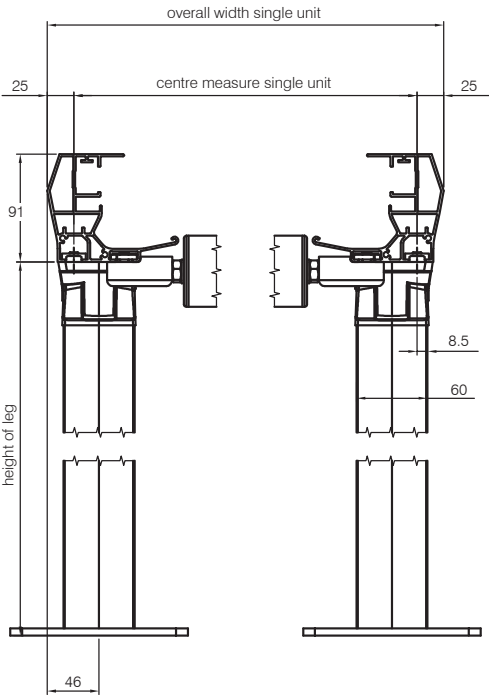

Single system

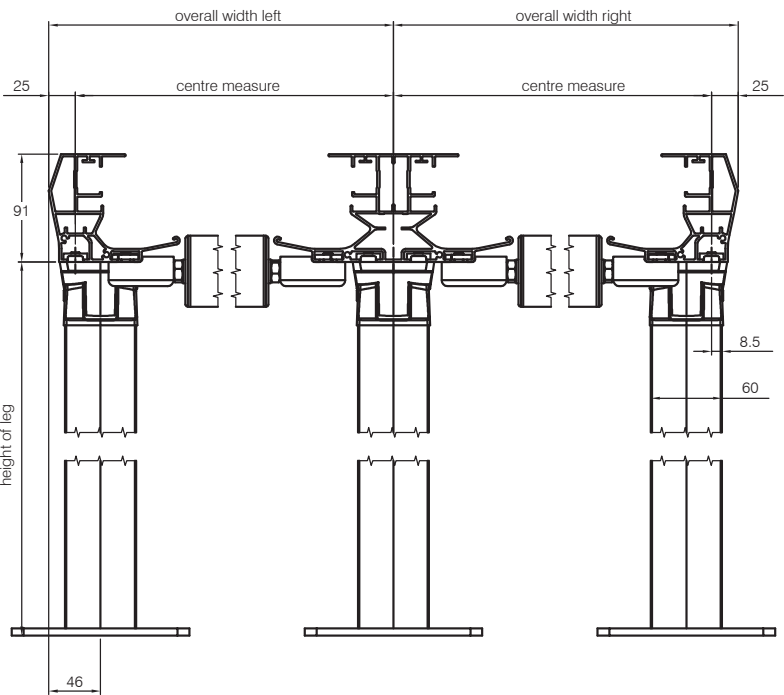

Coupled system

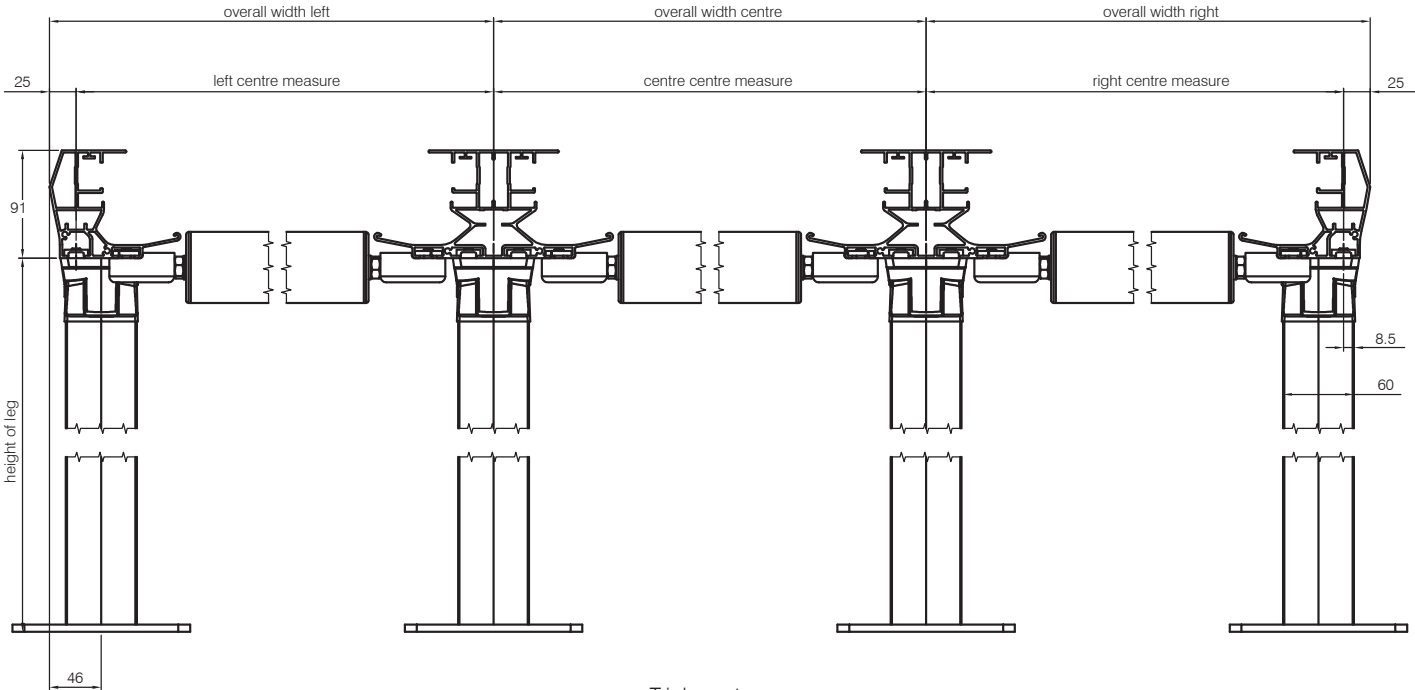

Triple system

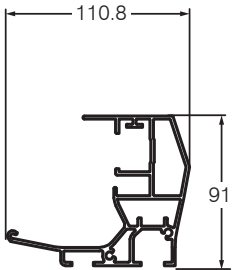

Single side channel

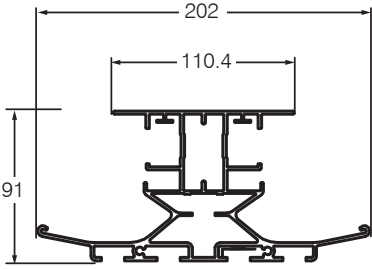

Double centre channel

Detail with zip side channels

